

# Inductive sensor

## NCB1,5-18GM60-E3-D-V1



- 1.5 mm flush
- Compression proof up to 350 bar, dynamic on active surface
- For applications in hydraulic cylinder

Inductive sensor



### Dimensions

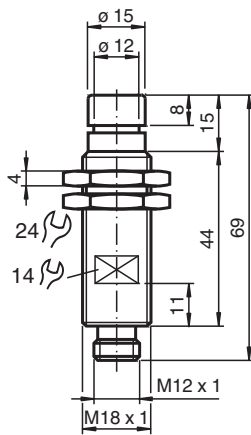

### Technical Data

General specifications		
Switching function		Normally closed (NC)
Output type		PNP
Rated operating distance	$s_n$	1.5 mm
Installation		flush
Output polarity		DC
Assured operating distance	$s_a$	0 ... 1.22 mm
Reduction factor $r_{304}$		0.5
Output type		3-wire
Nominal ratings		
Operating voltage	$U_B$	10 ... 60 V DC
Switching frequency	$f$	0 ... 1500 Hz
Hysteresis	$H$	typ. 5 %
Reverse polarity protection		reverse polarity protected
Short-circuit protection		pulsing
Voltage drop	$U_d$	$\leq 2.5$ V
Operating current	$I_L$	0 ... 200 mA

Release date: 2022-07-13 Date of issue: 2022-07-13 Filename: 321676\_eng.pdf

Refer to "General Notes Relating to Pepperl+Fuchs Product Information".

Pepperl+Fuchs Group  
www.pepperl-fuchs.com

USA: +1 330 486 0001  
fa-info@us.pepperl-fuchs.com

Germany: +49 621 776 1111  
fa-info@de.pepperl-fuchs.com

Singapore: +65 6779 9091  
fa-info@sg.pepperl-fuchs.com

**PF** PEPPERL+FUCHS

## Technical Data

No-load supply current	$I_0$	$\leq 10 \text{ mA}$
<b>Limit data</b>		
Operating pressure		350 bar (5076.4 psi)
<b>Functional safety related parameters</b>		
MTTF <sub>d</sub>		1240 a
Mission Time (T <sub>M</sub> )		20 a
Diagnostic Coverage (DC)		0 %
<b>Compliance with standards and directives</b>		
Standard conformity		
Standards		EN 60947-5-2:2007 EN 60947-5-2/A1:2012 IEC 60947-5-2:2007 IEC 60947-5-2 AMD 1:2012
<b>Approvals and certificates</b>		
UL approval		cULus Listed, General Purpose
CCC approval		Certified by China Compulsory Certification (CCC)
<b>Ambient conditions</b>		
Ambient temperature		-35 ... 80 °C (-31 ... 176 °F)
<b>Mechanical specifications</b>		
Connection type		Connector plug M12 x 1, 4-pin
Housing material		Stainless steel 1.4305 / AISI 303
Sensing face		Epoxy (black)
Degree of protection		IP67

## Connection

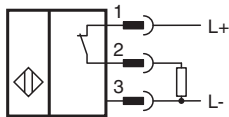

## Connection Assignment

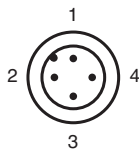

Wire colors in accordance with EN 60947-5-2

1	BN	(brown)
2	WH	(white)
3	BU	(blue)
4	BK	(black)

**Installation Conditions**

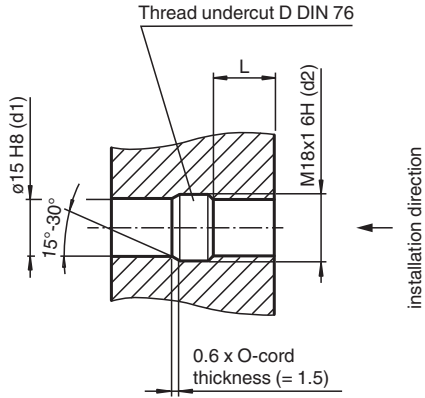

L: recommended installation depth:  $L \geq 0.8 \times d2$

**Accessories**

	<p><b>V1-G-2M-PUR</b></p>	<p>Female cordset single-ended M12 straight A-coded, 4-pin, PUR cable grey</p>
	<p><b>V1-W-2M-PUR</b></p>	<p>Female cordset single-ended M12 angled A-coded, 4-pin, PUR cable grey</p>

Release date: 2022-07-13 Date of issue: 2022-07-13 Filename: 321676\_eng.pdf

## Installation

### Note

Please refer to the technical information about this product at [www.pepperl-fuchs.com](http://www.pepperl-fuchs.com). This information describes the necessary geometry of the installation space!